

CATALOGO RIVETTI A STRAPPO

BLIND RIVETS CATALOGUE

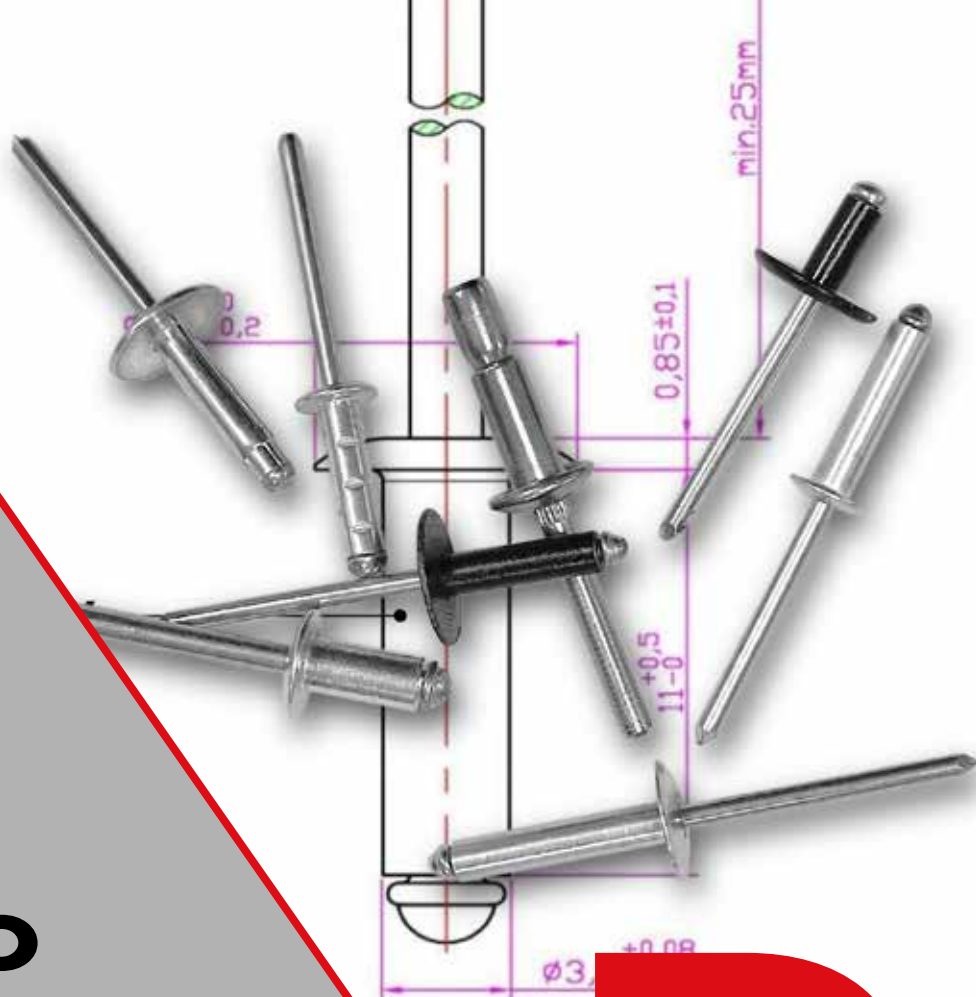

DEFREMM
COLD FORMING EXPERT
— — —

DEFREMM S.p.A.



Via Goito, 6 - 23900 Lecco LC



Tel. (+39) 0341 251410



info@defremm.it



Ed. 01 - 2023



INDICE

INDEX

Legenda rivetti a strappo	
<i>Rived nut code No. key</i>	1

CATALOGO - CATALOGUE

Rivetti alluminio/acciaio zincato testa tonda <i>Blind rivets aluminum/zinc plated steel dome head</i>	
RIALACTT	2
Rivetti alluminio/acciaio zincato testa svasata <i>Blind rivets aluminum/zinc plated steel countersunk head</i>	
RIALACTS	6
Rivetti alluminio/acciaio zincato testa larga <i>Blind rivets aluminum/zinc plated steel large</i>	
RIALACTL.....	8
Rivetti alluminio/acciaio zincato testa extra larga <i>Blind rivets aluminum/zinc plated steel extraozarge head</i>	
RIALACTXL.....	9
Rivetti alluminio/inox A2 testa tonda <i>Blind rivets aluminum/stainless steel a2 dome head</i>	
RIALA2TT.....	10
Rivetti per materie plastiche a fiore alluminio/acciaio zincato testa tonda <i>Peel rivets aluminum/zinc plated steel dome head</i>	
RIALACTTFI.....	11
Rivetti per materie plastiche a tre ali alluminio/alluminio testa tonda <i>Blind rivets for plastic three wings aluminum/aluminum dome head</i>	
RIALALTT3A	12
Rivetti tenuta stagna alluminio/acciaio testa tonda <i>Sealed blind rivets aluminum/steel dome head</i>	
RIALACTTST	13
Rivetti multigrip alluminio/acciaio zincato testa tonda <i>Multigrip blind rivets aluminum/zinc plated steel dome head</i>	
RIALACTTMG	14
Rivetti multigrip alluminio/inox A2 testa tonda <i>Multigrip blind rivets aluminum/stainless steel A2 dome head</i>	
RIALA2TTMG	15
Rivetti acciaio zincato/acciaio zincato testa tonda <i>Blind rivets zinc plated steel/ zinc plated steel dome head</i>	
RIACACTT	16

Rivetti acciaio zincato / acciaio zincato testa svasata <i>Blind rivets zinc plated steel/ zinc plated steel countersunk head</i> RIACACTS	18
Rivetti multigrip acciaio zincato / acciaio zincato testa tonda <i>Multigrip blind rivets steel zinc plated / steel zinc plated dome head</i> RIACACTTMG.....	19
Rivetti strutturali DEFBOLT acciaio zincato / acciaio zincato testa tonda <i>DEFBOLT structural rivets steel zinc plated/ steel zinc plated dome head</i> RIACACTTDB.....	20
Rivetti strutturali DEFBOLT acciaio zincato / acciaio zincato testa svasata <i>DEFBOLT structural rivets steel zinc plated / steel zinc plated countersunk head</i> RIACACTSDB	20
Rivetti strutturali DEFLOCK acciaio zincato / acciaio zincato testa tonda <i>DEFLOCK structural rivets steel zinc plated/ steel zinc plated dome head</i> RIACACTTDL.....	21
Rivetti strutturali DEFHLOCK acciaio zincato / acciaio zincato testa tonda <i>DEFHLOCK structural rivets zinc plated steel / zinc plated steel dome head</i> RIACACTTDH.....	21
Rivetti inox A2/inox A2 testa tonda <i>Blind rivets stainless steel A2/stainless steel A2 dome head</i> RIA2A2TT	22
Rivetti inox A2 / inox A2 testa svasata <i>Blind rivets stainless steel A2/stainless steel A2 countersunkhead</i> RIA2A2TS	25
Rivetti inox A4 / inox A4 testa tonda <i>Blind rivets stainless steel A4/stainless steel A4 dome head</i> RIA4A4TT	26
Rivetti tenuta stagna acciaio inox 304/acc. inox 420 testa tonda <i>Sealed blind rivets stainless steel 304/stainless steel 420 dome head</i> RIA2A2TTST	28
Rivetti strutturali DEFBOLT inox A2 / inox A2 testa tonda <i>DEFBOLT structural blind rivets stainless steel A2 / stainless steel A2 dome head</i> RIA2A2TTDB.....	29
Rivetti strutturali DEFBOLT inox A2 / inox A2 testa svasata <i>DEFBOLT structural blind rivets stainless steel A2 /stainless steel A2 countersunkhead</i> RIA2A2TSDB.....	29
Rivetti strutturali DEFHLOCK inox A2 / inox A2 testa tonda <i>DEFHLOCK structural blind rivets stainless steel A2 / stainless steel A2 dome head</i> RIA2A2TTDH.....	30

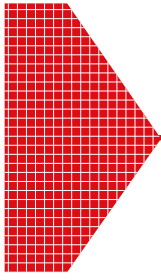

NOTE

NOTE

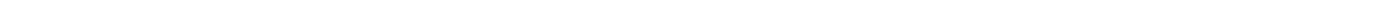

LEGENDA RIVETTI A STRAPPO

BLIND RIVET CODE No. KEY

Esempio di codice

example code

RI AL AC 40 10 TT FI

Tipologia Articolo
Article type

RI: rivetti a strappo - *Blind rivets*

Materiale boccola
Body material

AC: acciaio zincato - *Zinc plated steel*
A2: inox A2 - *A2 Inox*
A4: inox A4 - *A4 Inox*
AL: alluminio - *Aluminum*

Materiale chiodo
Mandrel material

AC: acciaio zincato - *Zinc plated steel*
A2: inox A2 - *A2 Inox*
A4: inox A4 - *A4 Inox*
AL: alluminio - *Aluminum*

Diametro
Diameter

mm: 2,4 - 3,0 - 3,2 - 4,0 - 4,8 - 5,0 - 6,0 - 6,4

Lunghezza
Length

Tipo testa
Head type

TT: tonda - *Domed*
TS: svasata - *Countersunk*
TL: larga - *Large*
TG: grande - *Extra large*

Caratteristiche speciali
Speciale features

MG: multigrip - <i>multigrip</i>	DB: strutturale DEFBOLT - <i>DEFBOLT structural</i>
ST: tenuta stagna - <i>sealed</i>	DL: strutturale DEFLOCK - <i>DEFLOCK structural</i>
3A: tre ali - <i>three wings</i>	DH: strutturale DEFHLOCK - <i>DEFHLOCK structural</i>
3AO: tre ali con o-ring - <i>three wings with o-ring</i>	RXXXX: colorati RAL - <i>RAL colored</i>
FI: fiore - <i>peel</i>	

RIVETTI ALLUMINIO/ACCIAIO ZINCATO TESTA TONDA

BLIND RIVETS ALUMINUM/ZINC PLATED STEEL DOME HEAD

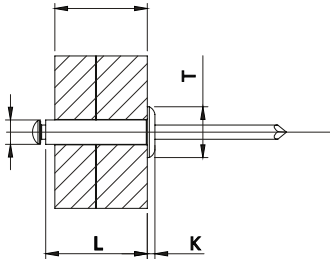

RIALACTT

Unit: mm

ØD ØD	L	CODICE CODE	S	ØF +0,10	ØT	K	Resistenza alla trazione N Tensile Strength N	Resistenza al taglio N Shear Strength N
2,4	4	RIALAC2404TT	0,5 - 2,0	2,5 - 2,6	5,0	1,0	350	250
	5	RIALAC2405TT	1,5 - 2,5					
	6	RIALAC2406TT	2,0 - 4,0					
	8	RIALAC2408TT	4,0 - 6,0					
	10	RIALAC2410TT	6,0 - 8,0					
	12	RIALAC2412TT	8,0 - 10,0					
3	4	RIALAC3004TT	0,5 - 1,5	3,1 - 3,2	6,3	1,3	550	400
	5	RIALAC3005TT	0,5 - 2,0					
	6	RIALAC3006TT	1,0 - 3,0					
	7	RIALAC3007TT	2,0 - 4,0					
	8	RIALAC3008TT	3,0 - 5,0					
	9	RIALAC3009TT	4,0 - 6,0					
	10	RIALAC3010TT	5,0 - 7,0					
	11	RIALAC3011TT	6,0 - 8,0					
	12	RIALAC3012TT	7,0 - 9,0					
	14	RIALAC3014TT	9,0 - 11,0					
	16	RIALAC3016TT	11,0 - 13,0					
	18	RIALAC3018TT	13,0 - 15,0					
20	RIALAC3020TT	15,0 - 17,0						
3,2	5	RIALAC3205TT	0,5 - 1,5	3,3 - 3,4	6,7	1,3	700	500
	6	RIALAC3206TT	0,5 - 2,0					
	7	RIALAC3207TT	1,0 - 3,0					
	8	RIALAC3208TT	2,0 - 4,0					
	9	RIALAC3209TT	3,0 - 5,0					

$\varnothing D$ $\varnothing D$	L	CODICE CODE	S	$\varnothing F$ +0,10	$\varnothing T$	K	Resistenza alla trazione N Tensile Strength N	Resistenza al taglio N Shear Strength N
3,2	10	RIALAC3210TT	4,0 - 6,0	3,3 - 3,4	6,7	1,3	700	500
	11	RIALAC3211TT	5,0 - 7,0					
	12	RIALAC3212TT	6,0 - 8,0					
	14	RIALAC3214TT	7,0 - 9,0					
	16	RIALAC3216TT	9,0 - 11,0					
	18	RIALAC3218TT	11,0 - 13,0					
	20	RIALAC3220TT	13,0 - 15,0					
	25	RIALAC3225TT	15,0 - 17,0					
4,0	5	RIALAC4005TT	0,5 - 1,5	4,1 - 4,2	8,4	1,7	1200	850
	6	RIALAC4006TT	1,0 - 3,0					
	7	RIALAC4007TT	2,0 - 3,5					
	8	RIALAC4008TT	3,0 - 5,0					
	9	RIALAC4009TT	4,0 - 5,5					
	10	RIALAC4010TT	5,0 - 6,5					
	11	RIALAC4011TT	6,0 - 7,5					
	12	RIALAC4012TT	6,5 - 8,5					
	14	RIALAC4014TT	8,5 - 10,5					
	16	RIALAC4016TT	10,5 - 12,5					
	18	RIALAC4018TT	12,5 - 14,5					
	20	RIALAC4020TT	12,5 - 16,5					
	22	RIALAC4022TT	16,5 - 18,5					
	24	RIALAC4024TT	18,5 - 20,5					
	26	RIALAC4026TT	20,5 - 22,5					
	28	RIALAC4028TT	22,0 - 24,5					
30	RIALAC4030TT	24,5 - 26,5						
35	RIALACL4035TT	26,5 - 31,5						
4,8	6	RIALAC4806TT	1,0 - 1,5	4,9 - 5,0	10,1	2,0	1700	1200
	7	RIALAC4807TT	1,5 - 3,0					
	8	RIALAC4808TT	1,5 - 3,5					
	9	RIALAC4809TT	3,5 - 5,0					
	10	RIALAC4810TT	3,5 - 5,5					
	11	RIALAC4811TT	5,5 - 7,0					
	12	RIALAC4812TT	5,5 - 7,5					
	14	RIALAC4814TT	7,5 - 9,0					
	16	RIALAC4816TT	9,0 - 11,0					
	18	RIALAC4818TT	11,0 - 13,0					



$\emptyset D$	L	CODICE CODE	S	$\emptyset F$ +0,10	$\emptyset T$	K	Resistenza alla trazione N Tensile Strength N	Resistenza al taglio N Shear Strength N
4,8	20	RIALAC4820TT	13,0 - 15,0	4,9 - 5,0	10,1	2,0	1700	1200
	22	RIALAC4822TT	15,0 - 17,0					
	24	RIALAC4824TT	17,0 - 19,0					
	26	RIALAC4826TT	19,0 - 21,0					
	28	RIALAC4828TT	20,0 - 23,0					
	30	RIALAC4830TT	22,0 - 25,0					
	35	RIALAC4835TT	25,0 - 30,0					
	40	RIALAC4840TT	30,0 - 35,0					
	45	RIALAC4845TT	35,0 - 40,0					
	50	RIALAC4850TT	40,0 - 45,0					
5,0	6	RIALAC5006TT	1,0 - 1,5	5,1 - 5,2	10,1	2	2000	1400
	8	RIALAC5008TT	1,5 - 3,5					
	10	RIALAC5010TT	3,5 - 5,5					
	12	RIALAC5012TT	5,5 - 7,5					
	14	RIALAC5014TT	7,5 - 9,0					
	16	RIALAC5016TT	9,0 - 11,0					
	18	RIALAC5018TT	11,0 - 13,0					
	20	RIALAC5020TT	13,0 - 15,0					
	22	RIALAC5022TT	15,0 - 17,0					
	24	RIALAC5024TT	17,0 - 19,0					
	26	RIALAC5026TT	19,0 - 21,0					
	28	RIALAC5028TT	20,0 - 23,0					
	30	RIALAC5030TT	22,0 - 25,0					
	35	RIALAC5035TT	25,0 - 48,0					
	40	RIALAC5040TT	48,0 - 35,0					
	45	RIALAC5045TT	35,0 - 40,0					
	50	RIALAC5050TT	40,0 - 45,0					
	55	RIALAC5055TT	45,0 - 50,0					
60	RIALAC5060TT	50,0 - 55,0						
65	RIALAC5065TT	55,0 - 60,0						
70	RIALAC5070TT	60,0 - 65,0						



$\emptyset D$ $\emptyset D$	L	CODICE CODE	S	$\emptyset F$ +0,10	$\emptyset T$	K	Resistenza alla trazione N Tensile Strength N	Resistenza al taglio N Shear Strength N
6	8	RIALAC6008TT	2,0 - 3,0	6,1 - 6,2	12,6	2,5	4800	2100
	10	RIALAC6010TT	2,5 - 5,0					
	12	RIALAC6012TT	4,5 - 7,0					
	14	RIALAC6014TT	6,0 - 9,0					
	16	RIALAC6016TT	7,0 - 10,0					
	18	RIALAC6018TT	9,5 - 13,0					
	20	RIALAC6020TT	11,0 - 14,0					
	22	RIALAC6022TT	13,0 - 17,0					
	26	RIALAC6026TT	16,5 - 21,0					
	30	RIALAC6030TT	20,5 - 25,0					
	35	RIALAC6035TT	25,0 - 30,0					
	40	RIALAC6040TT	30,0 - 35,0					
6,4	10	RIALAC6410TT	2,0 - 5,0	6,5 - 6,6	134	27	3150	2200
	12	RIALAC6412TT	4,5 - 7,0					
	16	RIALAC6416TT	6,5 - 10,0					
	18	RIALAC6418TT	9,5 - 13,0					
	22	RIALAC6422TT	12,5 - 17,0					
	26	RIALAC6426TT	16,6 - 21,0					
	30	RIALAC6448TT	20,0 - 25,0					
	35	RIALAC6435TT	25,0 - 30,0					
	40	RIALAC6440TT	30,0 - 35,0					

RIVETTI ALLUMINIO/ACCIAIO ZINCATO TESTA SVASATA

BLIND RIVETS ALUMINUM/ZINC PLATED STEEL COUNTERSUNK HEAD

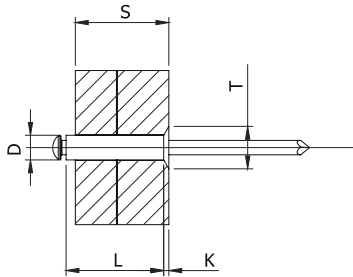

RIALACTS

Unit: mm

ØD ØD	L	CODICE CODE	S	ØF +0,10	Ø T	K	Resistenza alla trazione N Tensile Strength N	Resistenza al taglio N Shear Strength N
2,4	5	RIALAC2405TS	2,0 - 3,0	2,5 - 2,6	5,0	1,0	350	250
	6	RIALAC2406TS	2,0 - 4,0					
	8	RIALAC2408TS	4,0 - 6,0					
	10	RIALAC2410TS	6,0 - 8,0					
3,0	6	RIALAC3006TS	1,5 - 3,5	3,1 - 3,2	6,3	1,3	550	400
	7	RIALAC3007TS	2,0 - 4,0					
	8	RIALAC3008TS	3,5 - 5,5					
	9	RIALAC3009TS	4,0 - 6,0					
	10	RIALAC3010TS	5,5 - 7,0					
	11	RIALAC3011TS	6,0 - 8,0					
	12	RIALAC3012TS	7,0 - 9,0					
3,2	6	RIALAC3206TS	1,5 - 3,5	3,3 - 3,4	6,7	1,3	700	500
	7	RIALAC3207TS	2,0 - 4,0					
	8	RIALAC3208TS	3,0 - 5,0					
	9	RIALAC3209TS	4,0 - 6,0					
	10	RIALAC3210TS	5,0 - 7,0					
	11	RIALAC3211TS	6,0 - 8,0					
	12	RIALAC3212TS	7,0 - 9,0					
	14	RIALAC3214TS	8,0 - 11,0					
	16	RIALAC3216TS	10,5 - 13,0					

$\emptyset D$ $\emptyset D$	L	CODICE CODE	S	$\emptyset F$ +0,10	$\emptyset T$	K	Resistenza alla trazione N Tensile Strength N	Resistenza al taglio N Shear Strength N
4,0	6	RIALAC4006TS	1,5 - 3,0	4,1 - 4,2	8,4	1,7	1200	850
	7	RIALAC4007TS	2,5 - 4,0					
	8	RIALAC4008TS	3,0 - 5,0					
	9	RIALAC4009TS	3,5 - 6,0					
	10	RIALAC4010TS	5,0 - 7,0					
	11	RIALAC4011TS	5,5 - 8,0					
	12	RIALAC4012TS	7,0 - 9,0					
	14	RIALAC4014TS	8,5 - 11,0					
	16	RIALAC4016TS	10,5 - 13,0					
	18	RIALAC4018TS	12,5 - 15,0					
20	RIALAC4020TS	13,0 - 17,0						
4,8	7	RIALAC4807TS	2,5 - 4,0	4,9 - 5,0	10,1	2,0	1700	1200
	8	RIALAC4808TS	3,0 - 4,0					
	9	RIALAC4809TS	3,5 - 5,0					
	10	RIALAC4810TS	4,0 - 6,0					
	11	RIALAC4811TS	4,5 - 7,0					
	12	RIALAC4812TS	6,0 - 8,0					
	14	RIALAC4814TS	7,5 - 10,0					
	16	RIALAC4816TS	9,5 - 12,0					
	18	RIALAC4818TS	11,5 - 14,0					
	20	RIALAC4820TS	12,0 - 16,0					
	26	RIALAC4826TS	16,0 - 22,0					
	30	RIALAC4830TS	22,0 - 26,0					
35	RIALAC4835TS	25,0 - 30,0						

RIVETTI ALLUMINIO/ACCIAIO ZINCATO TESTA LARGA

BLIND RIVETS ALUMINUM/ZINC PLATED STEEL LARGE HEAD

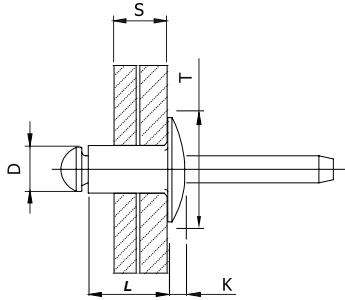

RIALACTL

Unit: mm

ØD ØD	L	CODICE CODE	S	ØF +0,10	ØT	K	Resistenza alla trazione N Tensile Strength N	Resistenza al taglio N Shear Strength N
3,2	6	RIALAC3206TL	1,0 - 3,0	3,3 - 3,4	8	2	700	500
	8	RIALAC3208TL	3,0 - 5,0					
	10	RIALAC3210TL	5,0 - 7,0					
	12	RIALAC3212TL	7,0 - 9,0					
	14	RIALAC3214TL	9,0 - 11,0					
	16	RIALAC3216TL	11,0 - 13,0					
4,0	6	RIALAC4006TL	1,0 - 3,0	4,1 - 4,2	10	2,5	1200	850
	8	RIALAC4008TL	3,0 - 5,0					
	10	RIALAC4010TL	5,0 - 6,5					
	12	RIALAC4012TL	6,5 - 8,5					
	14	RIALAC4014TL	8,5 - 10,5					
	16	RIALAC4016TL	10,5 - 12,5					
	20	RIALAC4020TL	12,5 - 16,5					
4,8	8	RIALAC4808TL	2,5 - 4,0	4,9 - 5,0	14	2,5	1700	1200
	10	RIALAC4810TL	4,0 - 6,0					
	12	RIALAC4812TL	6,0 - 8,0					
	14	RIALAC4814TL	7,5 - 10,0					
	16	RIALAC4816TL	9,5 - 12,0					
	18	RIALAC4818TL	11,5 - 14,0					
	20	RIALAC4820TL	13,5 - 16,0					
	24	RIALAC4824TL	16,0 - 20,0					
	26	RIALAC4826TL	19,5 - 22,0					
	30	RIALAC4830TL	22,0 - 25,0					
	35	RIALAC4835TL	25,0 - 48,0					
	40	RIALAC4840TL	30,0 - 35,0					

RIVETTI ALLUMINIO/ACCIAIO ZINCATO TESTA EXTRA LARGA

BLIND RIVETS ALUMINUM/ZINC PLATED STEEL EXTRALARGE HEAD

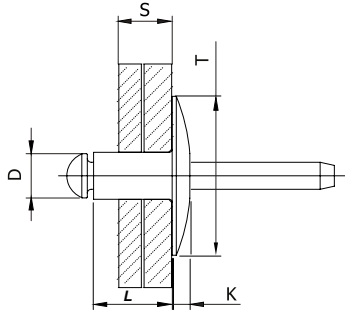

RIALACTXL

Unit: mm

$\varnothing D$ $\varnothing D$	L	CODICE CODE	S	$\varnothing F$ +0,10	$\varnothing T$	K	Resistenza alla trazione N Tensile Strength N	Resistenza al taglio N Shear Strength N
3,2	6	RIALAC3206TL	1,0 - 3,0	3,3 - 3,4	10	2	700	500
	8	RIALAC3208TL	3,0 - 5,0					
	10	RIALAC3210TL	5,0 - 7,0					
	12	RIALAC3212TL	7,0 - 9,0					
	14	RIALAC3214TL	9,0 - 11,0					
	16	RIALAC3216TL	11,0 - 13,0					
4,0	8	RIALAC4008TXL	3,0 - 5,0	4,1 - 4,2	12	2,5	1200	850
	10	RIALAC4010TXL	5,0 - 6,5					
	12	RIALAC4012TXL	6,5 - 8,5					
	14	RIALAC4014TXL	8,5 - 10,5					
	16	RIALAC4016TXL	10,5 - 12,5					
	20	RIALAC4020TXL	12,5 - 16,5					
4,8	8	RIALAC4808TXL	2,5 - 4,0	4,9 - 5,0	16	2,5	1700	1200
	10	RIALAC4810TXL	4,0 - 6,0					
	12	RIALAC4812TXL	6,0 - 8,0					
	14	RIALAC4814TXL	7,5 - 10,0					
	16	RIALAC4816TXL	9,5 - 12,0					
	18	RIALAC4818TXL	11,5 - 14,0					
	20	RIALAC4820TXL	13,5 - 16,0					
	24	RIALAC4824TXL	16,0 - 20,0					
	26	RIALAC4826TXL	19,5 - 22,0					
	30	RIALAC4830TXL	22,0 - 25,0					
	35	RIALAC4835TXL	25,0 - 30,0					
	40	RIALAC4840TXL	30,0 - 35,0					

RIVETTI ALLUMINIO/INOX A2 TESTA TONDA

BLIND RIVETS ALUMINUM/STAINLESS STEEL A2 DOME HEAD

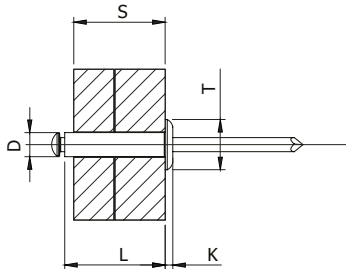

RIALA2TT

Unit: mm

ØD ØD	L	CODICE CODE	S	ØF +0,10	Ø T	K	Resistenza alla trazione N Tensile Strength N	Resistenza al taglio N Shear Strength N
3,0	6	RIALA23006TT	1,5 - 3,5	3,1 - 3,2	6,3	1,3	870	680
	8	RIALA23008TT	3,5 - 5,0					
	10	RIALA23010TT	5,0 - 7,0					
	12	RIALA23012TT	7,0 - 9,0					
	14	RIALA23014TT	9,0 - 11,0					
3,2	6	RIALA23206TT	1,5 - 3,5	3,3 - 3,4	6,7	1,3	760	980
	8	RIALA23208TT	3,5 - 5,5					
	10	RIALA23210TT	5,5 - 7,0					
	12	RIALA23212TT	7,0 - 9,0					
4,0	6	RIALA24006TT	1,5 - 3,0	4,1 - 4,2	8,4	1,7	1600	1200
	8	RIALA24008TT	3,0 - 5,0					
	10	RIALA24010TT	5,0 - 6,5					
	12	RIALA24012TT	6,5 - 8,5					
	14	RIALA24014TT	8,5 - 10,5					
	20	RIALA24020TT	12,5 - 16,5					
4,8	6	RIALA24806TT	0,5 - 2,5	4,9 - 5,0	10,1	2,0	2250	1700
	8	RIALA24808TT	2,5 - 4,0					
	10	RIALA24810TT	4,0 - 6,0					
	12	RIALA24812TT	6,0 - 8,0					
	14	RIALA24814TT	8,0 - 10,0					
	16	RIALA24816TT	10,0 - 12,0					
	18	RIALA24818TT	12,0 - 14,0					
	20	RIALA24820TT	14,0 - 16,0					
	26	RIALA24826TT	16,0 - 22,0					
	20	RIALA24830TT	22,0 - 26,0					

RIVETTI PER MATERIE PLASTICHE A FIORE ALLUMINIO/ACCIAIO ZINCATO TESTA TONDA

PEEL RIVETS ALUMINUM/ZINC PLATED STEEL DOME HEAD

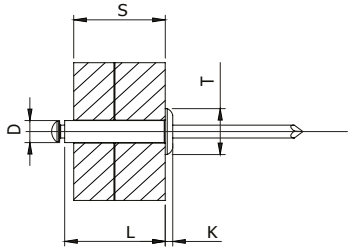

RIALACTTFI

Unit: mm

ØD ØD	L	CODICE CODE	S	ØF +0,10	ØT	K	Resistenza alla trazione N Tensile Strength N	Resistenza al taglio N Shear Strength N
4,0	10	RIALAC4010TTFI	1,5 - 3,0	4,5	8,4	1,7	1150	1260
	12	RIALAC4012TTFI	4,0 - 6,0					
	14	RIALAC4014TTFI	6,0 - 9,0					
	16	RIALAC4016TTFI	8,0 - 11,0					
	18	RIALAC4018TTFI	10,0 - 13,0					
	20	RIALAC4020TTFI	12,0 - 15,0					
	25	RIALAC4025TTFI	15,0 - 20,0					
	30	RIALAC4030TTFI	18,0 - 24,0					
4,8	10	RIALAC4810TTFI	0,5 - 4,0	5,3	10,1	2,0	1800	1600
	12	RIALAC4812TTFI	2,0 - 6,0					
	14	RIALAC4814TTFI	4,0 - 8,0					
	16	RIALAC4816TTFI	6,0 - 10,0					
	18	RIALAC4818TTFI	8,0 - 12,0					
	20	RIALAC4820TTFI	10,0 - 14,0					
	24	RIALAC4824TTFI	12,0 - 16,0					
	25	RIALAC4825TTFI	15,0 - 19,0					
	30	RIALAC4830TTFI	19,0 - 24,0					
	35	RIALAC4835TTFI	24,0 - 29,0					
	40	RIALAC4840TTFI	29,0 - 34,0					
	45	RIALAC4845TTFI	33,0 - 38,0					
50	RIALAC4850TTFI	38,0 - 43,0						

RIVETTI PER MATERIE PLASTICHE A TRE ALI ALLUMINIO/ALLUMINIO TESTA TONDA

BLIND RIVETS FOR PLASTIC THREE WINGS ALUMINUM/ALUMINUM DOME HEAD

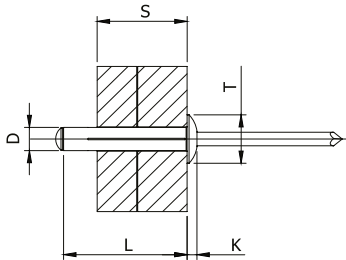

RIALALTT3A

**SU RICHIESTA
ON DEMAND**

Unit: mm

$\varnothing D$ $\varnothing D$	L	CODICE CODE	S	$\varnothing F$ +0,10	$\varnothing T$	K	Resistenza alla trazione N Tensile Strength N	Resistenza al taglio N Shear Strength N
4,0	13,6	RIALAL4014TT3A	1,0 - 3,0	4,2 - 4,5	8,2	1,6	500	800
	18,8	RIALAL4019TT3A	3,0 - 7,0					
4,8	15,3	RIALAL4815TT3A	1,0 - 3,0	5,0 - 5,3	10,1	2,1	900	1100
	20,5	RIALAL4821TT3A	3,0 - 9,0					
	24,5	RIALAL4825TT3A	5,0 - 12,0					

RIVETTI TENUTA STAGNA ALLUMINIO/ACCIAIO TESTA TONDA

SEALED BLIND RIVETS ALUMINUM/STEEL DOME HEAD

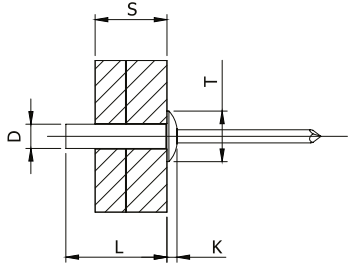

RIALACTTST

Unit: mm

$\varnothing D$ $\varnothing D$	L	CODICE CODE	S	$\varnothing F$ +0,10	$\varnothing T$	K	Resistenza alla trazione N Tensile Strength N	Resistenza al taglio N Shear Strength N
3,2	6,5	RIALAC3206TTST	0,5 - 2,0	3,3 - 3,4	6,7	1,3	1450	1100
	8	RIALAC3208TTST	2,0 - 3,5					
	9,5	RIALAC3210TTST	3,5 - 5,0					
	11	RIALAC3211TTST	5,0 - 6,5					
	12,5	RIALAC3212TTST	6,5 - 8,0					
4,0	8	RIALAC4008TTST	1,5 - 3,5	4,1 - 4,2	8,4	1,7	2200	1600
	9,5	RIALAC4010TTST	3,5 - 5,0					
	11	RIALAC4011TTST	4,5 - 6,5					
	12,5	RIALAC4012TTST	6,5 - 8,0					
	14	RIALAC4014TTST	8,0 - 10,5					
4,8	8	RIALAC4808TTST	1,0 - 3,0	4,9 - 5,0	10,1	2,0	3100	2200
	9,5	RIALAC4810TTST	3,0 - 4,5					
	11	RIALAC4811TTST	4,5 - 6,0					
	12,5	RIALAC4812TTST	4,5 - 7,5					
	14	RIALAC4814TTST	7,5 - 9,0					
	16	RIALAC4816TTST	9,0 - 11,0					
	18	RIALAC4818TTST	11,0 - 13,0					
	20	RIALAC4820TTST	13,0 - 16,0					
	25	RIALAC4825TTST	16,0 - 20,0					

RIVETTI MULTIGRIP ALLUMINIO/ACCIAIO ZINCATO TESTA TONDA

MULTIGRIP BLIND RIVETS ALUMINUM/ZINC PLATED STEEL DOME HEAD

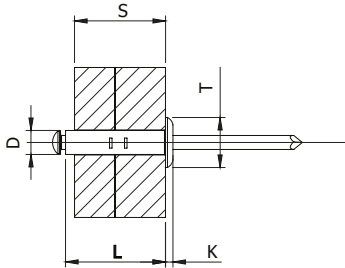

RIALACTTMG

Unit: mm

ØD ØD	L	CODICE CODE	S	ØF +0,10	Ø T	K	Resistenza alla trazione N Tensile Strength N	Resistenza al taglio N Shear Strength N
3,0	6	RIALAC3006TTMG	0,5 - 3,0	4,5	8,4	1,7	1150	1260
	8	RIALAC3008TTMG	1,0 - 5,0					
	10	RIALAC3010TTMG	2,0 - 6,5					
	12	RIALAC3012TTMG	5,0 - 9,5					
3,2	6	RIALAC3206TTMG	0,5 - 4,0	5,3	10,1	2,0	1800	1600
	8	RIALAC3208TTMG	1,0 - 4,8					
	9,5	RIALAC3210TTMG	1,2 - 6,5					
	11	RIALAC3211TTMG	4,0 - 7,9					
	12,5	RIALAC3212TTMG	5,0 - 9,5					
	14	RIALAC3214TTMG	6,5 - 11,0					
4,0	8	RIALAC4008TTMG	0,5 - 4,7	5,3	10,1	2,0	1800	1600
	9,5	RIALAC4010TTMG	1,2 - 6,3					
	12,5	RIALAC4012TTMG	4,0 - 9,5					
	17	RIALAC4017TTMG	6,4 - 12,7					
	18	RIALAC4018TTMG	9,5 - 14,5					
	20	RIALAC4020TTMG	11,5 - 16,5					
4,8	10	RIALAC4810TTMG	0,5 - 5,5	5,3	10,1	2,0	1800	1600
	11	RIALAC4811TTMG	1,3 - 6,5					
	12,5	RIALAC4813TTMG	3,0 - 7,5					
	15	RIALAC4815TTMG	4,8 - 11,0					
	17	RIALAC4817TTMG	6,4 - 12,7					
	20	RIALAC4820TTMG	10,0 - 15,0					
	24,8	RIALAC4825TTMG	12,7 - 19,8					
	27	RIALAC4827TTMG	17,0 - 23,0					
48	RIALAC4830TTMG	20,0 - 25,0						

RIVETTI MULTIGRIP ALLUMINIO/INOX A2 TESTA TONDA

MULTIGRIP BLIND RIVETS ALUMINUM/STAINLESS STEEL A2 DOME HEAD

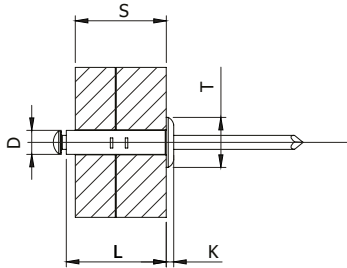

RIALA2TTMG

Unit: mm

ØD ØD	L	CODICE CODE	S	ØF +0,10	Ø T	K	Resistenza alla trazione N Tensile Strength N	Resistenza al taglio N Shear Strength N
3,0	6	RIALA23008TTMG	0,5 - 3,0	3,1	6,0	1,3	810	620
	9,5	RIALA23010TTMG	2,0 - 6,5					
	12,5	RIALA23013TTMG	5,0 - 9,5					
3,2	8	RIALA23208TTMG	0,5 - 5,0	3,3	6,0	1,3	980	680
	9,5	RIALA23210TTMG	2,0 - 6,5					
	12,5	RIALA23213TTMG	5,0 - 9,5					
4,0	9,5	RIALA24009TTMG	0,5 - 6,0	4,1	8,0	1,7	1600	1150
	12,5	RIALA24012TTMG	4,0 - 9,0					
	16,9	RIALA24016TTMG	8,5 - 13,5					
4,8	10	RIALA24810TTMG	0,5 - 5,5	5,0	9,5	2,0	2350	1500
	12,5	RIALA24813TTMG	3,0 - 7,5					
	15	RIALA24815TTMG	5,1 - 10,0					
	16,9	RIALA24816TTMG	6,9 - 12,0					
	20	RIALA24820TTMG	10,0 - 15,0					
	24,8	RIALA24824TTMG	14,0 - 19,5					

RIVETTI ACCIAIO ZINCATO/ACCIAIO ZINCATO TESTA TONDA

BLIND RIVETS ZINC PLATED STEEL/ ZINC PLATED STEEL DOME HEAD

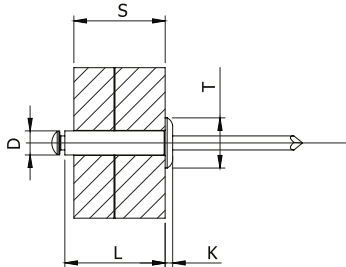

RIACACTT

Unit: mm

$\varnothing D$ $\varnothing D$	L	CODICE CODE	S	$\varnothing F$ +0,10	$\varnothing T$	K	Resistenza alla trazione N Tensile Strength N	Resistenza al taglio N Shear Strength N
3,0	5	RIACAC3005TT	0,5 - 2,0	3,1 - 3,2	6,3	1,3	1100	950
	6	RIACAC3006TT	0,5 - 3,0					
	7	RIACAC3007TT	2,0 - 4,0					
	8	RIACAC3008TT	3,0 - 5,0					
	9	RIACAC3009TT	4,0 - 6,0					
	10	RIACAC3010TT	5,0 - 7,0					
	11	RIACAC3011TT	6,0 - 8,0					
	12	RIACAC3012TT	7,0 - 9,0					
	14	RIACAC3014TT	9,0 - 11,0					
3,2	6	RIACAC3206TT	0,5 - 3,0	3,3 - 3,4	6,7	1,3	1200	1100
	7	RIACAC3207TT	3,0 - 4,0					
	8	RIACAC3208TT	3,0 - 5,0					
	9	RIACAC3209TT	5,0 - 6,0					
	10	RIACAC3210TT	5,0 - 6,5					
	11	RIACAC3211TT	7,0 - 8,0					
	12	RIACAC3212TT	6,5 - 9,0					
	14	RIACAC3214TT	9,0 - 11,0					
	16	RIACAC3216TT	9,0 - 12,0					
4,0	6	RIACAC4006TT	0,5 - 2,5	4,1 - 4,2	8,4	1,7	2200	1700
	7	RIACAC4007TT	2,0 - 3,5					
	8	RIACAC4008TT	2,5 - 5,0					
	9	RIACAC4009TT	4,0 - 5,5					
	10	RIACAC4010TT	5,0 - 6,5					
	11	RIACAC4011TT	6,0 - 7,5					
	12	RIACAC4012TT	6,8 - 8,5					



$\varnothing D$ $\varnothing D$	L	CODICE CODE	S	$\varnothing F$ +0,10	$\varnothing T$	K	Resistenza alla trazione N Tensile Strength N	Resistenza al taglio N Shear Strength N
4,0	14	RIACAC4014TT	8,5 - 10,5	4,1 - 4,2	8,4	1,7	2200	1700
	16	RIACAC4016TT	10,5 - 12,0					
	18	RIACAC4018TT	12,5 - 14,5					
	20	RIACAC4020TT	14,0 - 16,5					
	24	RIACAC4024TT	16,0 - 20,5					
	30	RIACAC4030TT	16,0 - 25,0					
4,8	6	RIACAC4806TT	0,5 - 2,0	4,9 - 5,0	10,1	2,0	3100	2900
	7	RIACAC4807TT	1,5 - 3,0					
	8	RIACAC4808TT	1,6 - 4,0					
	9	RIACAC4809TT	3,5 - 5,0					
	10	RIACAC4810TT	4,0 - 6,0					
	11	RIACAC4811TT	5,5 - 7,0					
	12	RIACAC4812TT	6,0 - 8,0					
	14	RIACAC4814TT	8,0 - 9,5					
	16	RIACAC4816TT	9,5 - 12,0					
	18	RIACAC4818TT	11,5 - 14,0					
	20	RIACAC4820TT	14,0 - 16,0					
	24	RIACAC4824TT	16,0 - 20,0					
	26	RIACAC4826TT	17,5 - 22,0					
	30	RIACAC4830TT	16,0 - 25,0					
5,0	10	RIACAC5010TT	4,0 - 6,0	5,1 - 5,2	10,5	2,1	4000	3100
	12	RIACAC5012TT	6,0 - 8,0					
	14	RIACAC5014TT	8,0 - 9,5					
	16	RIACAC5016TT	9,5 - 11,5					
6,0	10	RIACAC6010TT	3,0 - 4,0	6,1 - 6,2	12,6	2,5	4800	4300
	12	RIACAC6012TT	3,5 - 7,0					
	15	RIACAC6015TT	6,5 - 10,0					
	18	RIACAC6018TT	10,0 - 13,0					
	22	RIACAC6022TT	12,5 - 17,0					
	26	RIACAC6026TT	16,5 - 21,0					
	30	RIACAC6030TT	20,5 - 25,0					
6,4	10	RIACAC6410TT	2,0 - 4,0	6,5 - 6,6	13,4	2,7	5700	4900
	12	RIACAC6412TT	3,5 - 7,0					
	15	RIACAC6415TT	6,5 - 10,0					
	18	RIACAC6418TT	9,5 - 13,0					
	22	RIACAC6422TT	13,0 - 16,0					
	26	RIACAC6426TT	16,5 - 21,0					
	30	RIACAC6430TT	16,0 - 24,0					

RIVETTI ACCIAIO ZINCATO / ACCIAIO ZINCATO TESTA SVASATA

BLIND RIVETS ZINC PLATED STEEL/ ZINC PLATED STEEL COUNTERSUNK HEAD

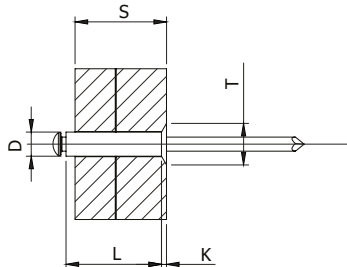

RIACACTS

Unit: mm

ØD ØD	L	CODICE CODE	S	ØF +0,10	Ø T	K	Resistenza alla trazione N Tensile Strength N	Resistenza al taglio N Shear Strength N
3,0	6	RIACAC3006TS	1,5 - 3,0	3,1 - 3,2	6,3	1,3	1100	950
	8	RIACAC3008TS	3,0 - 5,0					
	10	RIACAC3010TS	5,0 - 7,0					
	12	RIACAC3012TS	7,0 - 9,0					
3,2	6	RIACAC3206TS	1,5 - 3,0	3,3 - 3,4	6,7	1,3	1200	1100
	8	RIACAC3208TS	3,0 - 5,0					
	10	RIACAC3210TS	5,0 - 7,0					
	12	RIACAC3212TS	7,0 - 9,0					
	14	RIACAC3214TS	8,0 - 11,0					
4,0	6	RIACAC4006TS	1,5 - 2,5	4,1 - 4,2	8,4	1,7	2200	1700
	8	RIACAC4008TS	2,5 - 4,5					
	10	RIACAC4010TS	4,5 - 6,5					
	12	RIACAC4012TS	6,5 - 8,5					
	14	RIACAC4014TS	8,5 - 10,5					
	16	RIACAC4016TS	10,5 - 12,5					
4,8	8	RIACAC4808TS	1,5 - 4,0	4,9 - 5,0	10,1	2,0	3100	2900
	10	RIACAC4810TS	4,0 - 6,0					
	12	RIACAC4812TS	5,5 - 7,5					
	14	RIACAC4814TS	7,0 - 9,0					
	16	RIACAC4816TS	9,0 - 11,5					
	20	RIACAC4820TS	11,0 - 15,0					
	22	RIACAC4822TS	15,0 - 17,5					

RIVETTI MULTIGRIP ACCIAIO ZINCATO / ACCIAIO ZINCATO TESTA TONDA

MULTIGRIP BLIND RIVETS STEEL ZINC PLATED / STEEL ZINC PLATED DOME HEAD

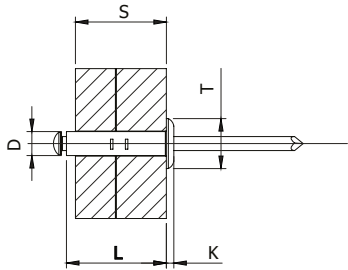

RIACACTTMG

Unit: mm

ØD ØD	L	CODICE CODE	S	ØF +0,10	ØT	K	Resistenza alla trazione N Tensile Strength N	Resistenza al taglio N Shear Strength N
3,2	7	RIACAC3207TTMG	0,5 - 4,0	3,3 - 3,4	6,7	1,3	1300	900
	9	RIACAC3209TTMG	1,5 - 6,0					
	11	RIACAC3211TTMG	2,5 - 8,0					
4,0	10,8	RIACAC4011TTMG	1,5 - 6,0	4,1 - 4,2	8,4	1,7	1800	1500
	13	RIACAC4013TTMG	2,0 - 8,0					
	15	RIACAC4015TTMG	3,0 - 10					
4,8	10	RIACAC4810TTMG	1,5 - 5,0	4,9 - 5,0	10,1	2,0	2900	2600
	11	RIACAC4811TTMG	1,5 - 6,0					
	12	RIACAC4812TTMG	2,0 - 7,0					
	14	RIACAC4814TTMG	3,0 - 9,0					
	17,5	RIACAC4818TTMG	5,0 - 12,0					

RIVETTI STRUTTURALI DEFBOLT ACCIAIO ZINCATO / ACCIAIO ZINCATO TESTA TONDA

DEFBOLT STRUCTURAL RIVETS STEEL ZINC PLATED / STEEL ZINC PLATED DOME HEAD

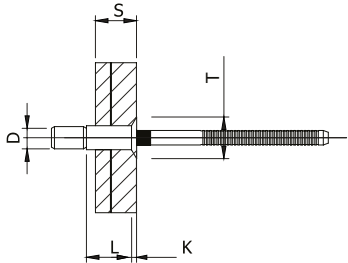

RIACACTTDB

Unit: mm

ØD ØD	L	CODICE CODE	S	ØF +0,10	Ø T	K	Resistenza alla trazione N Tensile Strength N	Resistenza al taglio N Shear Strength N
4,8	10	RIACAC4810TTDB	1,6 - 6,9	4,9 - 5,2	10,2	2,3	4500	5800
	14	RIACAC4814TTDB	1,6 - 11,1					
6,4	14	RIACAC6414TTDB	2,0 - 9,5	6,6 - 7,0	13,5	3,0	8200	11000
	20	RIACAC6420TTDB	2,0 - 15,9					

RIVETTI STRUTTURALI DEFBOLT ACCIAIO ZINCATO / ACCIAIO ZINCATO TESTA SVASATA

DEFBOLT STRUCTURAL RIVETS STEEL ZINC PLATED / STEEL ZINC PLATED COUNTERSUNK HEAD

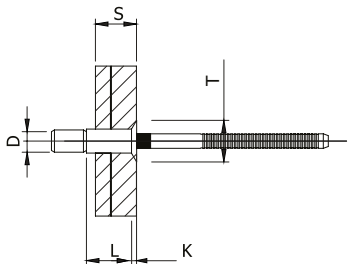

RIACACTSDB

Unit: mm

ØD ØD	L	CODICE CODE	S	ØF +0,10	Ø T	K	Resistenza alla trazione N Tensile Strength N	Resistenza al taglio N Shear Strength N
4,8	13	RIACAC4813TSDB	3,2 - 8,2	4,9 - 5,1	8,5	2,2	4500	5800
	16	RIACAC4816TSDB	3,2 - 12,2					
6,4	17	RIACAC6417TSDB	3,2 - 12,2	6,6 - 7,0	10,5	2,4	8200	11000
	22	RIACAC6422TSDB	5,0 - 17,5					

RIVETTI STRUTTURALI DEFLOCK ACCIAIO ZINCATO / ACCIAIO ZINCATO TESTA TONDA

DEFLOCK STRUCTURAL RIVETS STEEL ZINC PLATED/ STEEL ZINC PLATED DOME HEAD

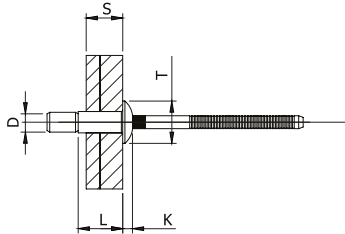

RIACACTTDL

Unit: mm

ØD ØD	L	CODICE CODE	S	ØF +0,10	Ø T	K	Resistenza alla trazione N Tensile Strength N	Resistenza al taglio N Shear Strength N
4,8	10	RIACAC4810TTDL	1,6 - 6,9	4,9 - 5,2	10,2	2,3	4500	6000
	14	RIACAC4814TTDL	1,6 - 11,1					
6,4	14	RIACAC6414TTDL	2,0 - 9,5	6,6 - 7,0	13,5	3,0	8400	11000
	20	RIACAC6420TTDL	2,0 - 15,9					

RIVETTI STRUTTURALI DEFHLOCK ACCIAIO ZINCATO / ACCIAIO ZINCATO TESTA TONDA

DEFHLOCK STRUCTURAL RIVETS ZINC PLATED STEEL / ZINC PLATED STEEL DOME HEAD

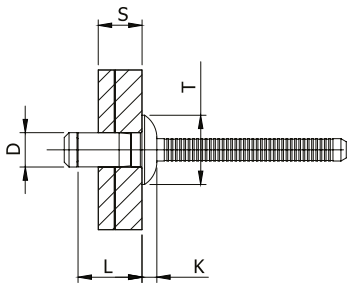

RIACACTTDH

Unit: mm

ØD ØD	L	CODICE CODE	S	ØF +0,10	Ø T	K	Resistenza alla trazione N Tensile Strength N	Resistenza al taglio N Shear Strength N
6,4	10	RIACAC6410TTDH	2,8 - 4,8	6,7- 6,9	13,4	2,7	7000	11200
	12	RIACAC6412TTDH	4,8 - 6,8					11200
	14	RIACAC6414TTDH	6,8 - 8,8					12000
	16	RIACAC6416TTDH	8,8 - 10,8					12000
	18	RIACAC6418TTDH	10,8 - 12,8					12000
	20	RIACAC6420TTDH	12,8 - 14,8					12000

RIVETTI INOX A2/INOX A2 TESTA TONDA

BLIND RIVETS STAINLESS STEEL A2/STAINLESS STEEL A2 DOME HEAD

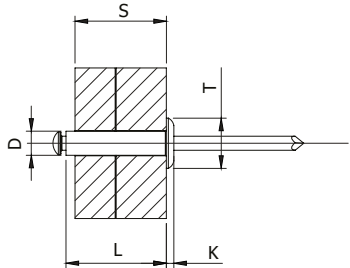

RIA2A2TT

Unit: mm

ØD ØD	L	CODICE CODE	S	ØF +0,10	Ø T	K	Resistenza alla trazione N Tensile Strength N	Resistenza al taglio N Shear Strength N
2,4	4	RIA2A22404TT	0,5 - 2,0	2,5 - 2,6	5,0	1,0	1500	1000
	6	RIA2A22406TT	2,0 - 4,0					
	8	RIA2A22408TT	4,0 - 6,0					
3,0	6	RIA2A23006TT	1,5 - 2,5	3,1 - 3,2	6,3	1,3	2200	1800
	8	RIA2A23008TT	2,5 - 4,5					
	10	RIA2A23010TT	4,5 - 6,5					
	12	RIA2A23012TT	6,5 - 8,5					
	16	RIA2A23016TT	8,2 - 12,5					
3,2	6	RIA2A23206TT	1,5 - 2,5	3,3 - 3,4	6,7	1,3	2500	1900
	8	RIA2A23208TT	2,5 - 4,5					
	10	RIA2A23210TT	4,5 - 6,5					
	12	RIA2A23212TT	6,5 - 8,5					
	14	RIA2A23214TT	8,2 - 10,5					
	16	RIA2A23216TT	10,5 - 12,5					
	18	RIA2A23218TT	12,0 - 14,0					
4,0	6	RIA2A24006TT	0,5 - 3,0	4,1 - 4,2	8,4	1,7	3500	2700
	8	RIA2A24008TT	3,0 - 4,0					
	10	RIA2A24010TT	3,0 - 5,0					
	12	RIA2A24012TT	3,0 - 4,0					
	14	RIA2A24014TT	3,0 - 5,0					
	16	RIA2A24016TT	3,0 - 4,0					
	18	RIA2A24012TT	3,0 - 5,0					
	20	RIA2A24014TT	3,0 - 4,0					
	25	RIA2A24016TT	3,0 - 5,0					



$\emptyset D$ $\emptyset D$	L	CODICE CODE	S	$\emptyset F$ +0,10	$\emptyset T$	K	Resistenza alla trazione N Tensile Strength N	Resistenza al taglio N Shear Strength N
4,8	6	RIA2A24806TT	1,0 - 2,0	4,9 - 5,0	10,1	2,0	5000	4800
	8	RIA2A24808TT	1,5 - 3,0					
	10	RIA2A24810TT	3,0 - 5,0					
	12	RIA2A24812TT	5,0 - 7,0					
	14	RIA2A24814TT	7,0 - 9,0					
	16	RIA2A24816TT	9,0 - 11,0					
	18	RIA2A24818TT	11,0 - 13,0					
	20	RIA2A24820TT	13,0 - 15,0					
	22	RIA2A24822TT	15,0 - 17,0					
	24	RIA2A24824TT	16,0 - 18,0					
	25	RIA2A24825TT	17,0 - 20,0					
	26	RIA2A24826TT	18,0 - 20,0					
	30	RIA2A24830TT	20,0 - 25,0					
	35	RIA2A24835TT	25,0 - 30,0					
40	RIA2A24840TT	30,0 - 34,0						
5,0	8	RIA2A25008TT	2,0 - 4,0	5,1 - 5,2	10,5	2,1	5800	4700
	10	RIA2A25010TT	4,0 - 6,0					
	12	RIA2A25012TT	6,0 - 8,0					
	14	RIA2A25014TT	8,0 - 9,5					
	16	RIA2A25016TT	8,0 - 11,0					
	18	RIA2A25018TT	11,0 - 13,0					
	20	RIA2A25020TT	13,0 - 16,0					
	22	RIA2A25022TT	15,0 - 17,0					
	24	RIA2A25024TT	16,0 - 18,0					
	25	RIA2A25025TT	16,0 - 19,0					
	26	RIA2A25026TT	18,0 - 20,0					
	30	RIA2A25030TT	20,0 - 25,0					
	35	RIA2A25035TT	25,0 - 30,0					
	40	RIA2A25040TT	30,0 - 34,0					



$\emptyset D$ $\emptyset D$	L	CODICE CODE	S	$\emptyset F$ +0,10	$\emptyset T$	K	Resistenza alla trazione N Tensile Strength N	Resistenza al taglio N Shear Strength N
6,0	8	RIA2A26008TT	0,5 - 2,0	6,1 - 6,2	12,6	2,5	5000	4800
	10	RIA2A26010TT	2,0 - 4,0					
	12	RIA2A26012TT	4,0 - 6,0					
	14	RIA2A26014TT	6,0 - 8,0					
	16	RIA2A26016TT	8,0 - 10,0					
	18	RIA2A26018TT	10,0 - 12,0					
	20	RIA2A26020TT	12,0 - 14,0					
	22	RIA2A26022TT	14,0 - 19,0					
	24	RIA2A26024TT	19,0 - 24,0					
	25	RIA2A26025TT	24,0 - 29,0					
26	RIA2A26026TT	29,0 - 34,0						
6,4	10	RIA2A26410TT	2,0 - 4,0	6,5 - 6,6	13,4	2,7	8000	6000
	12	RIA2A26412TT	4,0 - 6,0					
	14	RIA2A26414TT	6,0 - 8,0					
	16	RIA2A26416TT	9,0 - 13,0					
	18	RIA2A26418TT	13,0 - 16,0					
	20	RIA2A26420TT	14,0 - 17,0					
	22	RIA2A26422TT	15,0 - 19,0					
	25	RIA2A26425TT	19,0 - 23,0					
	30	RIA2A26430TT	23,0 - 28,0					
	35	RIA2A26435TT	28,0 - 33,0					
40	RIA2A26440TT	28,0 - 33,0						

RIVETTI INOX A2 / INOX A2 TESTA SVASATA

BLIND RIVETS STAINLESS STEEL A2/STAINLESS STEEL A2 COUNTERSUNK HEAD

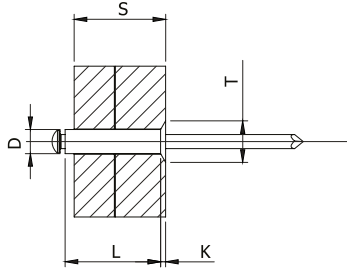

RIA2A2TS

Chiodo rullato
Rolled mandrel

Unit: mm

ØD ØD	L	CODICE CODE	S	ØF +0,10	Ø T	K	Resistenza alla trazione N Tensile Strength N	Resistenza al taglio N Shear Strength N
3,0	6	RIA2A23006TS	1,5 - 3,0	3,1 - 3,2	6,3	1,3	2200	1800
	8	RIA2A23008TS	3,0 - 5,0					
	10	RIA2A23010TS	5,0 - 6,5					
	12	RIA2A23012TS	6,5 - 8,0					
3,2	6	RIA2A23206TS	1,5 - 2,5	3,3 - 3,4	6,7	1,3	2500	1900
	8	RIA2A23208TS	2,5 - 4,5					
	10	RIA2A23210TS	4,5 - 6,5					
	12	RIA2A23212TS	6,5 - 8,5					
4,0	8	RIA2A24008TS	2,0 - 4,0	4,1 - 4,2	8,4	1,7	3500	2700
	10	RIA2A24010TS	4,0 - 6,0					
	12	RIA2A24012TS	6,0 - 8,0					
	14	RIA2A24014TS	8,0 - 10,0					
	16	RIA2A24016TS	10,0 - 12,0					
	18	RIA2A24018TS	12,0 - 14,0					
	20	RIA2A24020TS	14,0 - 16,0					
4,8	8	RIA2A24808TS	1,5 - 3,0	4,9 - 5,0	10,1	2,0	5000	4800
	10	RIA2A24810TS	3,0 - 5,0					
	12	RIA2A24812TS	5,0 - 7,0					
	14	RIA2A24814TS	7,0 - 9,0					
	16	RIA2A24816TS	9,0 - 11,0					
	18	RIA2A24818TS	11,0 - 13,0					
	20	RIA2A24820TS	13,0 - 15,0					
	25	RIA2A24825TS	15,0 - 17,0					
	30	RIA2A24830TS	17,0 - 19,0					

RIVETTI INOX A4 / INOX A4 TESTA TONDA

BLIND RIVETS STAINLESS STEEL A4/STAINLESS STEEL A4 DOME HEAD

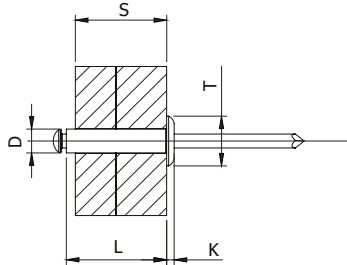

RIA4A4TT

Chiodo rullato

Rolled mandrel

Unit: mm

ØD ØD	L	CODICE CODE	S	ØF +0,10	Ø T	K	Resistenza alla trazione N Tensile Strength N	Resistenza al taglio N Shear Strength N
3,0	6	RIA4A43006TT	0,5 - 3,0	3,1 - 3,2	6,3	1,3	2200	1800
	8	RIA4A43008TT	3,0 - 5,0					
	10	RIA4A43010TT	3,0 - 6,5					
	12	RIA4A43012TT	6,5 - 8,5					
	14	RIA4A43014TT	8,5 - 10,5					
	16	RIA4A43016TT	10,5 - 12,5					
3,2	6	RIA4A43206TT	0,5 - 3,0	3,3 - 3,4	6,7	1,3	2500	1900
	8	RIA4A43208TT	3,0 - 5,0					
	10	RIA4A43210TT	3,0 - 6,5					
	12	RIA4A43212TT	6,5 - 8,5					
	14	RIA4A43214TT	8,5 - 10,5					
	16	RIA4A43216TT	10,5 - 12,5					
	18	RIA4A43218TT	12,0 - 14,0					
4,0	6	RIA4A44006TT	1,0 - 2,5	4,1 - 4,2	8,4	1,7	3500	2700
	8	RIA4A44008TT	2,5 - 4,5					
	10	RIA4A44010TT	4,5 - 6,5					
	12	RIA4A44012TT	6,5 - 8,5					
	14	RIA4A44014TT	8,5 - 10,0					
	16	RIA4A44016TT	10,0 - 12,0					
	18	RIA4A44018TT	12,0 - 14,0					
	20	RIA4A44020TT	14,0 - 16,0					
	25	RIA4A44025TT	16,0 - 21,0					



$\emptyset D$ $\emptyset D$	L	CODICE CODE	S	$\emptyset F$ +0,10	$\emptyset T$	K	Resistenza alla trazione N Tensile Strength N	Resistenza al taglio N Shear Strength N
4,8	6	RIA4A44806TT	1,5 - 2,0	4,9 - 5,0	10,1	2,0	5000	4000
	8	RIA4A44808TT	2,0 - 4,0					
	10	RIA4A44810TT	4,0 - 6,0					
	12	RIA4A44812TT	6,0 - 8,0					
	14	RIA4A44814TT	8,0 - 9,5					
	16	RIA4A44816TT	9,5 - 11,0					
	18	RIA4A44818TT	11,0 - 13,0					
	20	RIA4A44820TT	13,0 - 16,0					
	24	RIA4A44824TT	16,0 - 18,0					
	25	RIA4A44825TT	16,0 - 19,0					
	30	RIA4A44830TT	20,0 - 25,0					

RIVETTI TENUTA STAGNA ACCIAIO INOX 304/ACC. INOX 420 TESTA TONDA

SEALED BLIND RIVETS STAINLESS STEEL 304/STAINLESS STEEL 420 DOME HEAD

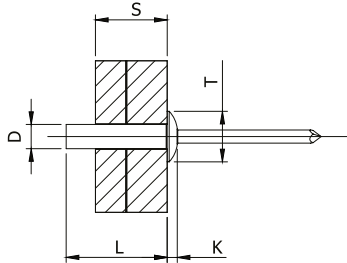

RIA2A2TTST

Unit: mm

$\varnothing D$ $\varnothing D$	L	CODICE CODE	S	$\varnothing F$ +0,10	$\varnothing T$	K	Resistenza alla trazione N Tensile Strength N	Resistenza al taglio N Shear Strength N
3,2	6	RIA2A23206TTST	0,5 - 1,5	3,3 - 3,4	6,7	1,3	2200	2000
	8	RIA2A23208TTST	1,5 - 3,0					
	9,5	RIA2A23210TTST	3,0 - 5,0					
	12	RIA2A23212TTST	5,0 - 6,5					
	16	RIA2A23214TTST	6,5 - 8,0					
4,0	6	RIA2A24006TTST	0,5 - 1,5	4,1 - 4,2	8,4	1,7	3500	3000
	8	RIA2A24008TTST	1,5 - 3,0					
	10	RIA2A24010TTST	3,0 - 5,0					
	12	RIA2A24012TTST	5,0 - 6,5					
	14	RIA2A24014TTST	6,5 - 8,0					
	16	RIA2A24016TTST	8,0 - 11,0					
4,8	8	RIA2A24808TTST	0,5 - 3,0	4,9 - 5,0	10,1	2,0	4400	4000
	9,5	RIA2A24810TTST	3,0 - 5,0					
	12	RIA2A24812TTST	5,0 - 6,5					
	14	RIA2A24814TTST	6,0 - 7,5					
	16	RIA2A24816TTST	6,5 - 9,0					
	20	RIA2A24020TTST	9,0 - 12,0					

RIVETTI STRUTTURALI DEFBOLT INOX A2 / INOX A2 TESTA TONDA

DEFBOLT STRUCTURAL BLIND RIVETS STAINLESS STEEL A2 / STAINLESS STEEL A2 DOME HEAD

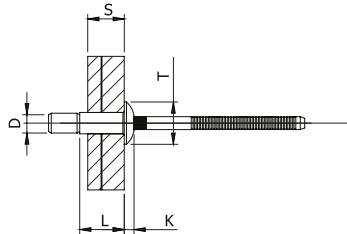

RIA2A2TTDB

Unit: mm

$\varnothing D$ $\varnothing D$	L	CODICE CODE	S	$\varnothing F$ +0,10	$\varnothing T$	K	Resistenza alla trazione N Tensile Strength N	Resistenza al taglio N Shear Strength N
4,8	10	RIA2A24810TTIB	1,6 - 6,9	4,9 - 5,2	10,2	2,5	4400	6000
	14	RIA2A24814TTIB	1,6 - 11,1					
6,4	14	RIA2A26414TTIB	2,0 - 9,5	6,6 - 7,0	13,5	3,2	8200	10500
	20	RIA2A26420TTIB	2,0 - 15,5					

RIVETTI STRUTTURALI DEFBOLT INOX A2 / INOX A2 TESTA SVASATA

DEFBOLT STRUCTURAL BLIND RIVETS STAINLESS STEEL A2 / STAINLESS STEEL A2 COUNTERSUNK HEAD

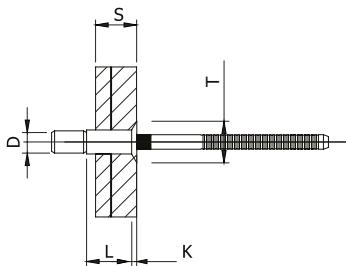

RIA2A2TSDB

Unit: mm

$\varnothing D$ $\varnothing D$	L	CODICE CODE	S	$\varnothing F$ +0,10	$\varnothing T$	K	Resistenza alla trazione N Tensile Strength N	Resistenza al taglio N Shear Strength N
4,8	12	RIA2A24812TSDB	3,6 - 7,9	4,9 - 5,1	9,0	2,0	4400	6000
	16	RIA2A24816TSDB	3,6 - 12,7					
6,4	16	RIA2A26416TSDB	5,0 - 12,0	6,6 - 7,0	11,0	2,2	8200	10500
	22	RIA2A26422TSDB	5,0 - 17,0					

RIVETTI STRUTTURALI DEFHLOCK INOX A2 / INOX A2 TESTA TONDA

DEFHLOCK STRUCTURAL BLIND RIVETS STAINLESS STEEL A2 / STAINLESS STEEL A2 DOME HEAD

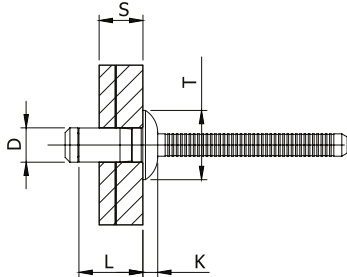

RIA2A2TTDH

Unit: mm

$\varnothing D$ $\varnothing D$	L	CODICE CODE	S	$\varnothing F$ +0,10	$\varnothing T$	K	Resistenza alla trazione N Tensile Strength N	Resistenza al taglio N Shear Strength N
6,4	10,5	RIA2A26410TTDH	2,0 - 4,5	6,7 - 6,9	13,4	3,2	8000	13500
	14,5	RIA2A26414TTDH	5,0 - 8,5					
	16,5	RIA2A26416TTDH	7,0 - 10,5					

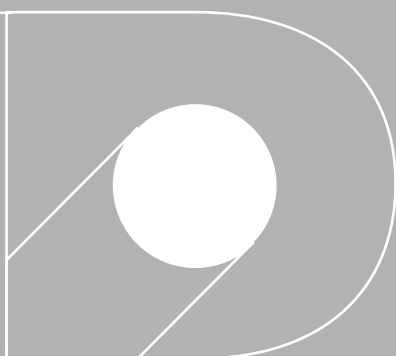

DEFREMM
COLD FORMING **EXPERT**

Via Goito, 6 - 23900 Lecco LC

Tel. (+39) 0341 251410

www.defremm.it - info@defremm.it